

# DC EXHIBIT C

## LEGEND:

HEAVY DUTY AC		SPOT ELEVATION (ABBREVIATION)	13.34 FG
LIGHT DUTY AC		MATCH (E) GRADE ELEVATION	13.61 AC MATCH (E)
HEAVY DUTY PCC		INTERMEDIATE CONTOURS	25
LIGHT DUTY PCC		INDEX CONTOUR	
LANDSCAPING		STORM DRAIN PIPE	XX"SD
CMU BLOCK WALL		DRAINAGE INLET	
AGGREGATE BUNKER		CONTECH 3 CARTRIDGE CATCHBASIN STORMFILTER	
FINISHED FLOOR ELEVATION	FF: 123.00	SURFACE FLOW / DRAINAGE FLOW	
		OVERLAND RELEASE	

## CONSTRUCTION KEYNOTES:

- 1 CONCRETE BARRIER CURB
- 2 MONOLITHIC CONCRETE CURB AND SIDEWALK
- 3 CONCRETE SIDEWALK
- 4 CONCRETE VALLEY GUTTER
- 5 ADA RAMP
- 6 "TYPE S" DRIVEWAY APRON PER CITY OF ROSEVILLE STD DTL ST-20
- 7 TRASH ENCLOSURE W/ CONCRETE APRON
- 8 20' X 20' AGGREGATE BUNKERS
- 9 CMU BLOCK WALL PER DETAIL 2, SHEET C6
- 10 FENCING
- 11 SLIDING GATE
- 12 SHORT-TERM BICYCLE PARKING
- 13 CURB CUT
- 14 PARKING STALL STRIPING PER DETAIL 1, SHEET C6
- 15 ZERO CURB

## DRAINAGE KEYNOTES:

- D1 CONNECT INTO (E) ONSITE DRAIN INLET
- D2 NYLOPLAST DRAIN BASIN (GRATE ELEVATED 6" ABOVE SWALE FLOWLINE)
- D3 CONTECH 3 CARTRIDGE CATCHBASIN STORMFILTER
- D4 VEGETATED SWALE
- D5 RIP-RAP OUTFALL

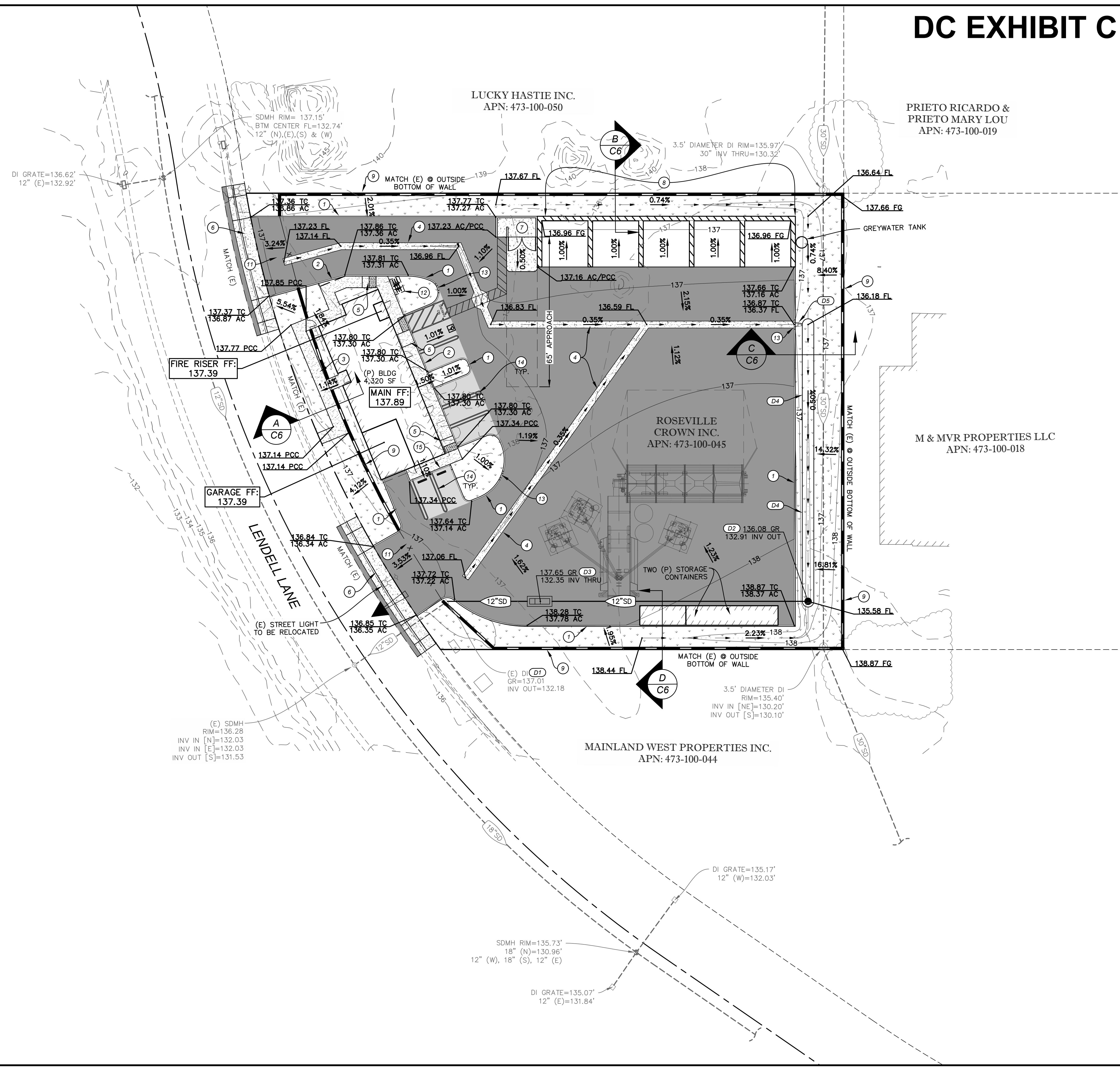

**NOT FOR CONSTRUCTION**

APPROVED	DATE	BY	REVISION

2021 LENDLELL LANE  
 ROSEVILLE, CA 95747  
 APN: 473-100-045  
**PRELIMINARY GRADING & DRAINAGE PLAN**

ROSEVILLE  
 LANDSCAPE MATERIAL  
 1801 PFE ROAD  
 ROSEVILLE, CA 95747  
 CONTACT: BALWINDER SINGH GILL  
 PH: (916) 709-6619

SHEET  
**C3**  
 3 OF 6  
 10/31/2025

**811**  
Know what's below.  
Call before you dig.  
or (800) 642-2444

W:\2022 Projects\22-131-2021 Lendell Ln Roseville WORKING CAD\C3 GRADING PLAN.dwg Oct 31, 2025 04:14 pm  
 (E) SDMH RIM=136.28  
 INV IN [N]=132.03  
 INV IN [E]=132.03  
 INV OUT [S]=131.53